

The M4V-Series In-line 5/2 and 5/3 Solenoid and Air actuated valves may be Manifold Mounted for multi-task applications. Each valve series has its unique manifold that is available in up to 16-valve stations. Each manifold has threaded common supply and exhaust ports. Valves are easy to install using a single interface gasket seal and fixing screws. Blanking plates are available for unused stations, allowing for valve expansion without the need to change the manifold.

Specification

| Item/Manifold Model | M 100M | M 200M | 300M | 400M |
|---------------------------|--|---------------------|---------------------|---------------------|
| Fluid | Air to be filtered by 40um filter element) | | | |
| Temperature °C | -20-70 | | | |
| Adaptable valve' s series | 4V100, 4A100 Series | 4V200, 4A200 Series | 4V300, 4A300 Series | 4V400, 4A400 Series |

Model/Ordering Codes

Ordering code contains the two parts of the manifold' s and the blank plate' s.

Model Code For Manifold

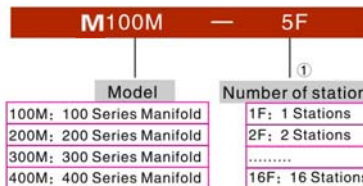

Model Code For Blank Plate

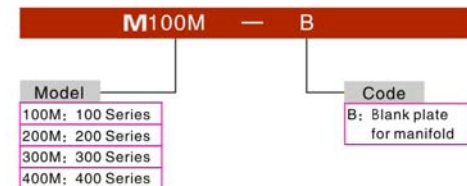

① 100M, 200M series have a maximum of 16 stations ; 300M series have a maximum of 12 stations; 400M series have a maximum of 8 stations.

Dimensions

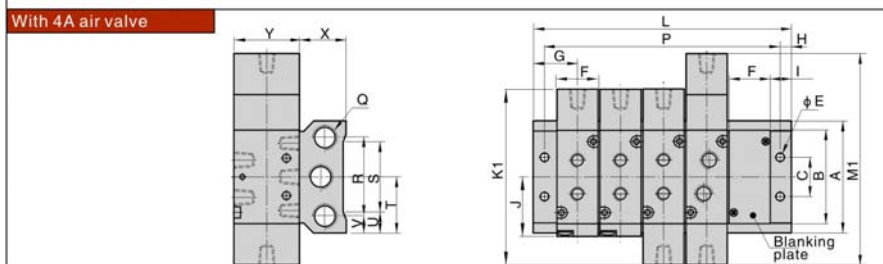
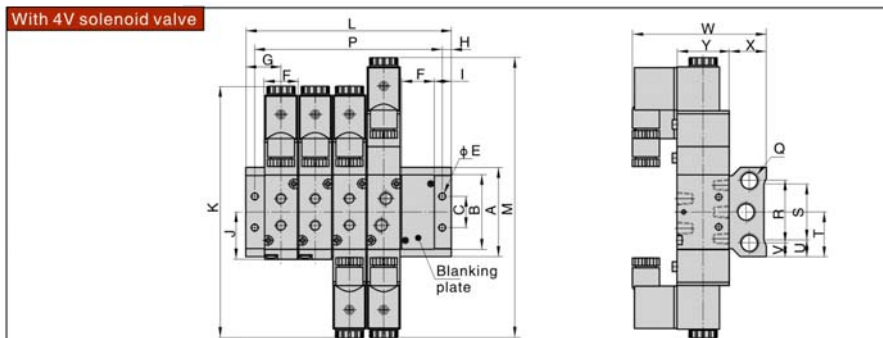

| Model/Item | A | B | C | E | F | G | H | I | J | L | | | | | | | | | |
|------------|-----|------|----|-----|------|------|---|------|------|----|----|-----|-----|-----|-----|-----|-----|-----|-----|
| | | | | | | | | | | 1F | 2F | 3F | 4F | 5F | 6F | 7F | 8F | 9F | 10F |
| 100M□F | 58 | 43.2 | 20 | 4.5 | 18.3 | 19 | 5 | 10 | 28.2 | 38 | 57 | 76 | 95 | 114 | 133 | 152 | 171 | 190 | 209 |
| 200M□F | 61 | 50.7 | 21 | 4.5 | 22.4 | 23 | 6 | 12 | 31.7 | 46 | 69 | 92 | 115 | 138 | 161 | 184 | 207 | 230 | 253 |
| 300M□F | 75 | 64.8 | 26 | 4.5 | 27.3 | 27 | 6 | 13.5 | 40 | 54 | 82 | 110 | 138 | 166 | 194 | 222 | 250 | 278 | 306 |
| 400M□F | 104 | 94.5 | 32 | 5.5 | 34.3 | 31.5 | 7 | 14.5 | 57 | 63 | 98 | 133 | 168 | 203 | 238 | 273 | 308 | - | - |

| Model/Item | L | | | | | | P | | | | | | | | | | | | | | | |
|------------|-----|-----|-----|-----|-----|-----|----|----|-----|-----|-----|-----|-----|-----|-----|-----|-----|-----|-----|-----|-----|-----|
| | 11F | 12F | 13F | 14F | 15F | 16F | 1F | 2F | 3F | 4F | 5F | 6F | 7F | 8F | 9F | 10F | 11F | 12F | 13F | 14F | 15F | 16F |
| 100M□F | 228 | 247 | 266 | 285 | 304 | 323 | 28 | 47 | 66 | 85 | 104 | 123 | 142 | 161 | 180 | 199 | 218 | 237 | 256 | 275 | 294 | 313 |
| 200M□F | 276 | 299 | 322 | 345 | 368 | 391 | 34 | 57 | 80 | 103 | 126 | 149 | 172 | 195 | 218 | 241 | 264 | 287 | 310 | 333 | 356 | 379 |
| 300M□F | 334 | 362 | - | - | - | - | 42 | 70 | 98 | 126 | 154 | 182 | 210 | 238 | 266 | 294 | 322 | 350 | - | - | - | - |
| 400M□F | - | - | - | - | - | - | 49 | 84 | 119 | 154 | 189 | 224 | 259 | 294 | - | - | - | - | - | - | - | - |

| Model/Item | K | K1 | M1 | M1 | Q | R | S | T | U | V | W | X | Y |
|------------|-------|-----|-------|-----|------|----|----|------|------|----|-------|----|----|
| 100M□F | 139.4 | 81 | 154.5 | 96 | 1/4" | 40 | 30 | 29 | 14 | 9 | 79 | 25 | 27 |
| 200M□F | 170 | 92 | 189 | 111 | 1/4" | 43 | 32 | 30.5 | 14.5 | 9 | 93 | 26 | 35 |
| 300M□F | 188.8 | 111 | 208 | 130 | 3/8" | 53 | 48 | 37.5 | 13.5 | 11 | 99.5 | 30 | 40 |
| 400M□F | 221.8 | 142 | 243 | 163 | 1/2" | 68 | 67 | 52 | 18.5 | 18 | 112.5 | 38 | 50 |

Product Features

1. Compact construction and easy to install.
2. Manifolds up to 16-stations are available.
3. Air and Solenoid Piloted valve may be mounted on the same manifold.
4. Common supply and exhausts through the manifold with threaded port connections both ends.
5. Interface gaskets for each station allows quick, leak free installation of valves.
6. Blanking plates allow for future valve expansion

