

Collet Fixtures

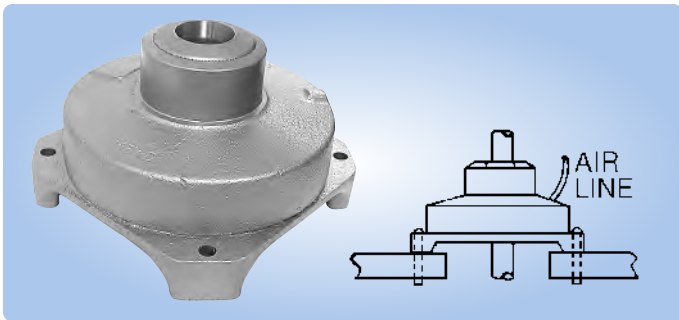

Use collet fixtures to evenly and firmly grip round bars during drilling, machining, positioning, or assembling tasks...without marring the surface of the bars.

Workpieces may pass through the fixture. Model PCF accepts standard 3C collets. Model LS-1 accepts standard 5C collets. A collet wrench is supplied to simplify collet installation and removal. Mead does not offer collets.

Double-acting collet fixtures must be actuated by a four-way valve. Model PCF will prevent a round, smooth bar from turning at up to 10 ft. lbs. of applied torque; model LS-1 at up to 40 ft. lbs. at 100 PSI.

Dimensions & Specifications

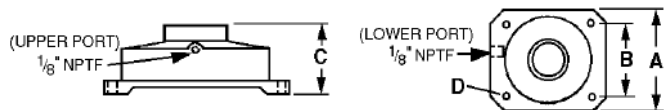

Model No.	Applied Holding Pressure @ 100 PSI; Max. 120 PSI	Collet Type	Round Stock Capacity	A (Sq.)	B (Sq.)	C	D (4)
PCF	3,400 lbs.	3C	1/2"	4 7/8"	4"	3 7/16"	.257"
LS-1	7,100 lbs.	5C	1"	7"	5 7/16"	4 9/16"	.390"